

GIGA - 90 × 200

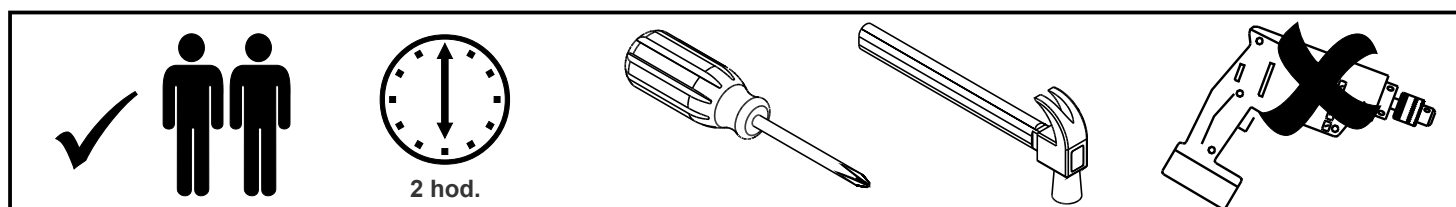

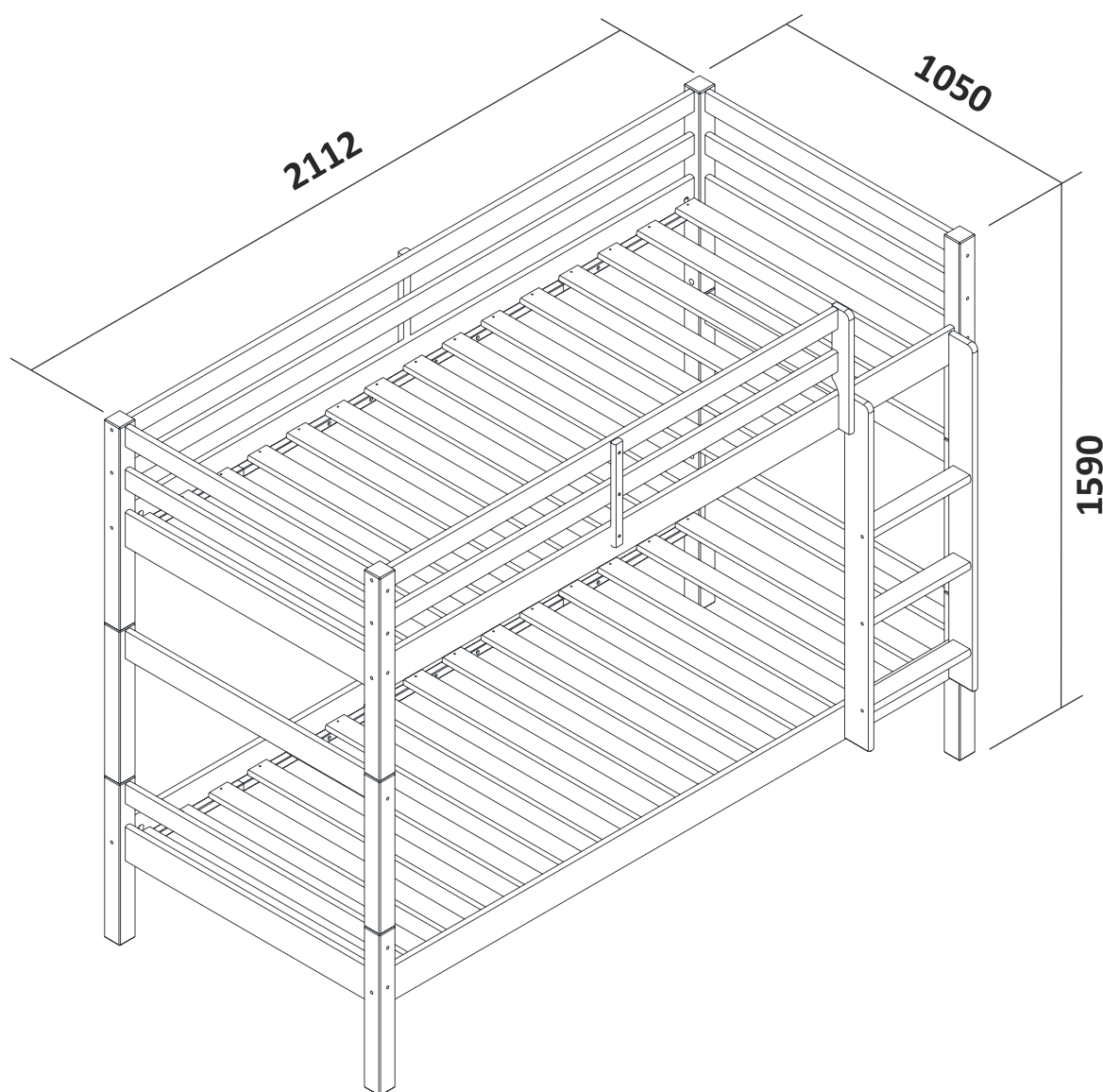
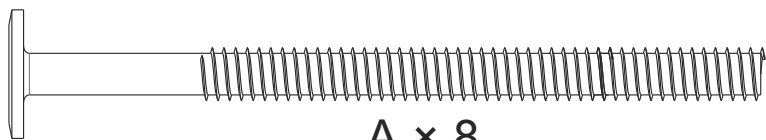

A × 8

rozměr: 6,35 × 100 mm



B × 8

rozměr: 6,35 × 100 mm

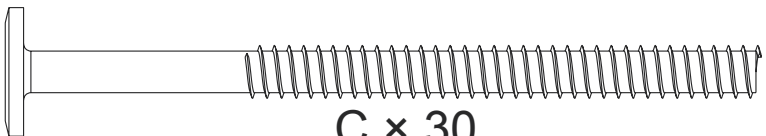

C × 30

rozměr: 7 × 100 mm

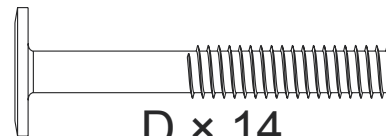

D × 14

rozměr: 7 × 50 mm

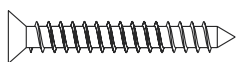

E × 64

rozměr: 4 × 30 mm

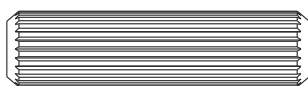

F × 54

rozměr: Ø 10 × 40 mm



Gx 46

rozměr: Ø 17 mm

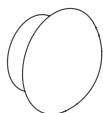

H × 16

rozměr: Ø 16 mm

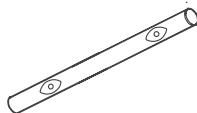

I × 8

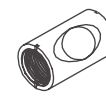

J × 16



K × 16

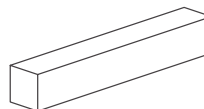

L × 2

rozměr: 70 mm

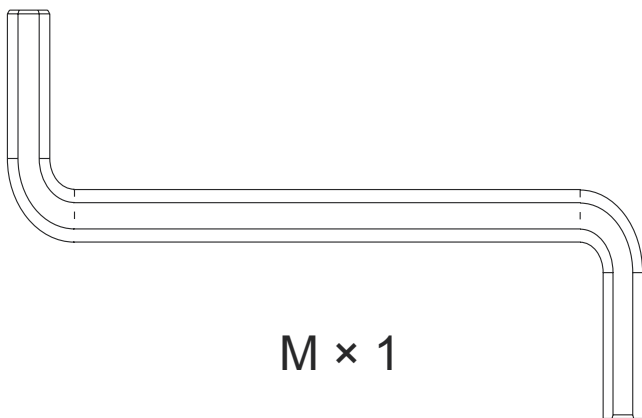

M × 1

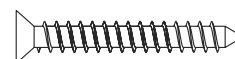

N × 6

rozměr: 4 × 30 mm



O × 14

rozměr: Ø 8 mm



P × 14

rozměr: Ø 10 mm

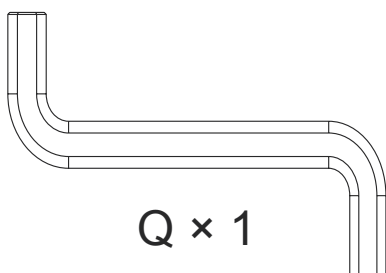

Q × 1

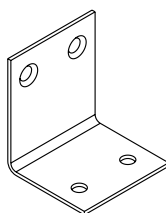

R × 2

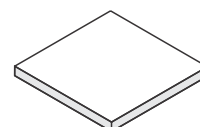

S × 8

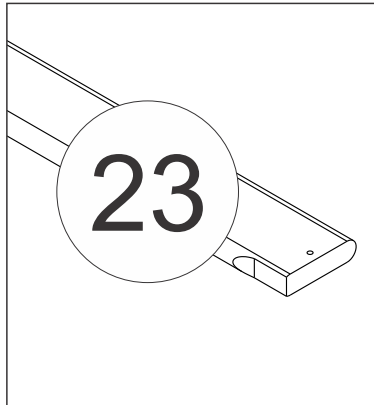
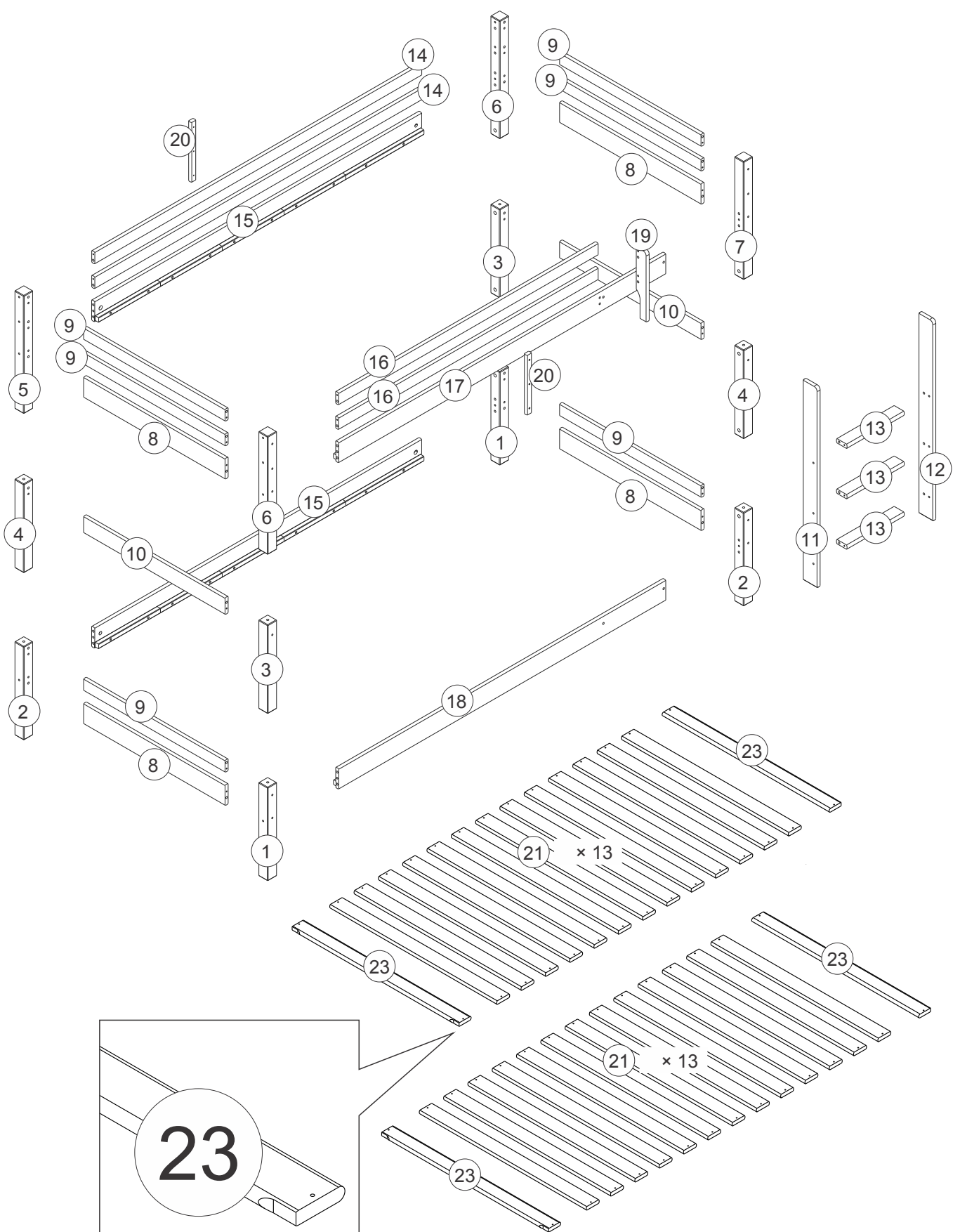

Giga 01

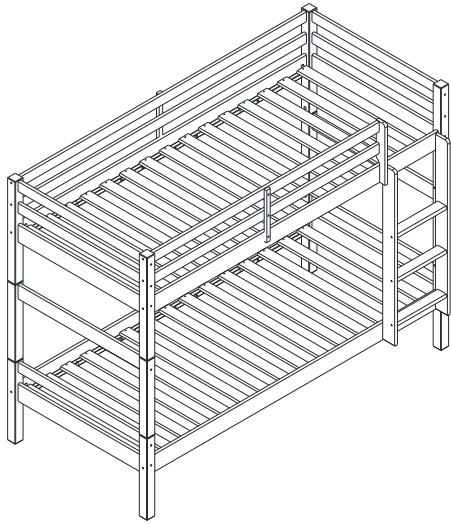

Giga 02

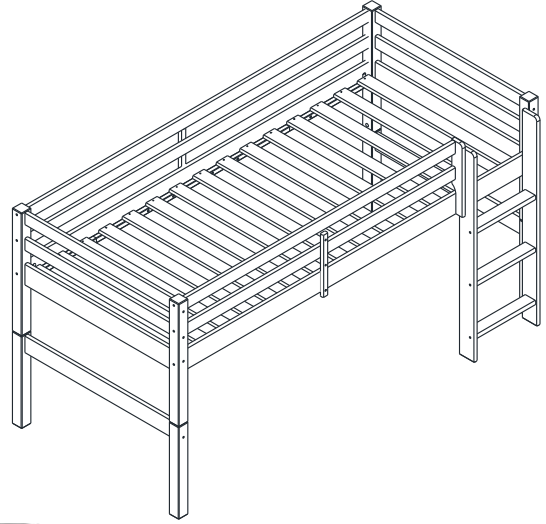

Giga 03

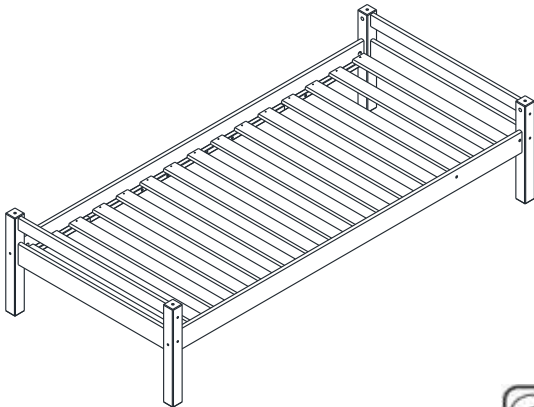

Giga 04

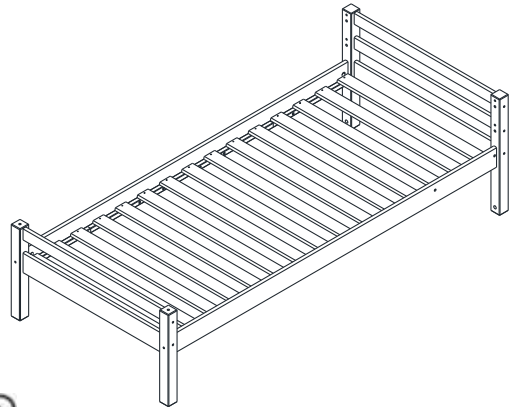

Giga 05

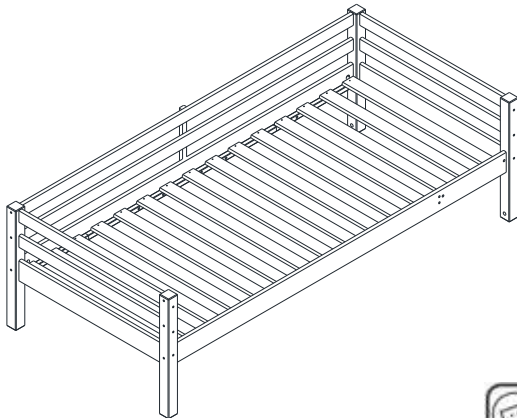

Giga 06

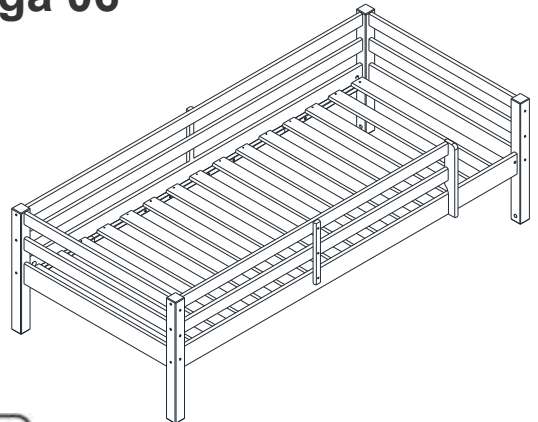

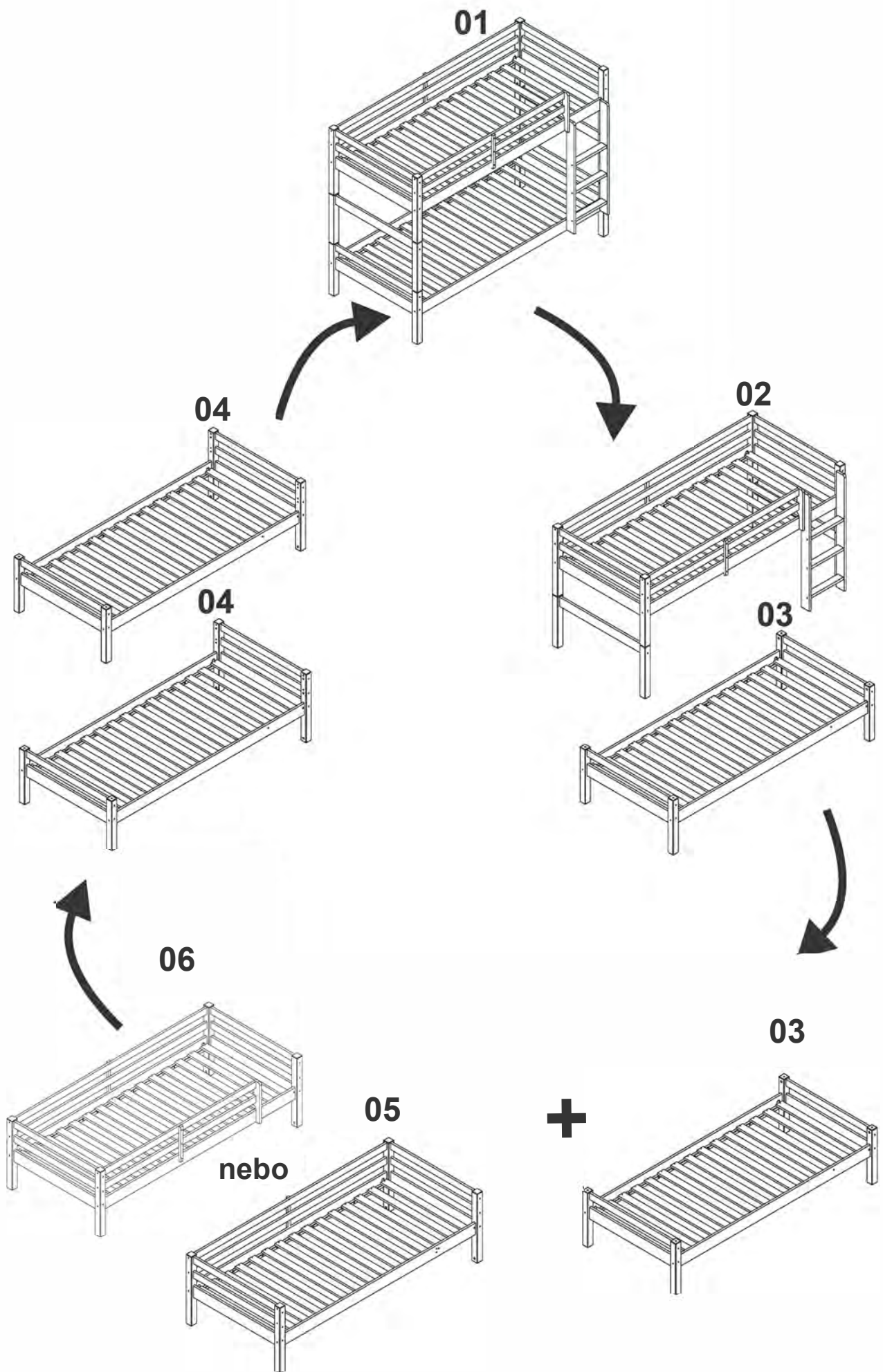

DŮLEŽITÉ INFORMACE

PŘEČTĚTE A USCHOVEJTE PRO POZDĚJŠÍ ZMĚNY SESTAVENÍ

- Po dokončení montáže pečlivě dotáhněte všechny spoje.
- Rošty jsou součástí dodávky.
- K postelím je nutno pořídit odpovídající matrace. Maximální rozměr matrací je 90 × 200 cm, maximální výška matrací je 15 cm.
- Palanda (horní pozice postele) není vhodná pro děti do 6 let věku.
- Pozor na nebezpečí pádu z horní postele.
- Tento výrobek by neměl být používán, pokud některá z jeho částí chybí nebo je poškozena.
- Pravidelně kontrolujte pevnost sestavy a dotažení všech spojů.
- K palandě nepřipevňujte žádná lana, pásy, dráty, šňůry nebo popruhy, hrozí nebezpečí úrazu.
- Při sestavení postelí do pozice nad sebou je nutno opatřit horní postel všemi bezpečnostními zábranami, jinak hrozí nebezpečí úrazu.
- Minimální vzdálenost mezi palandou a zdí musí být méně než 75 mm nebo více než 230 mm, jinak hrozí nebezpečí uvíznutí dítěte.
- Tento výrobek vyhovuje bezpečnostním požadavkům podle norem: EN 747-1 a 2 (2015).

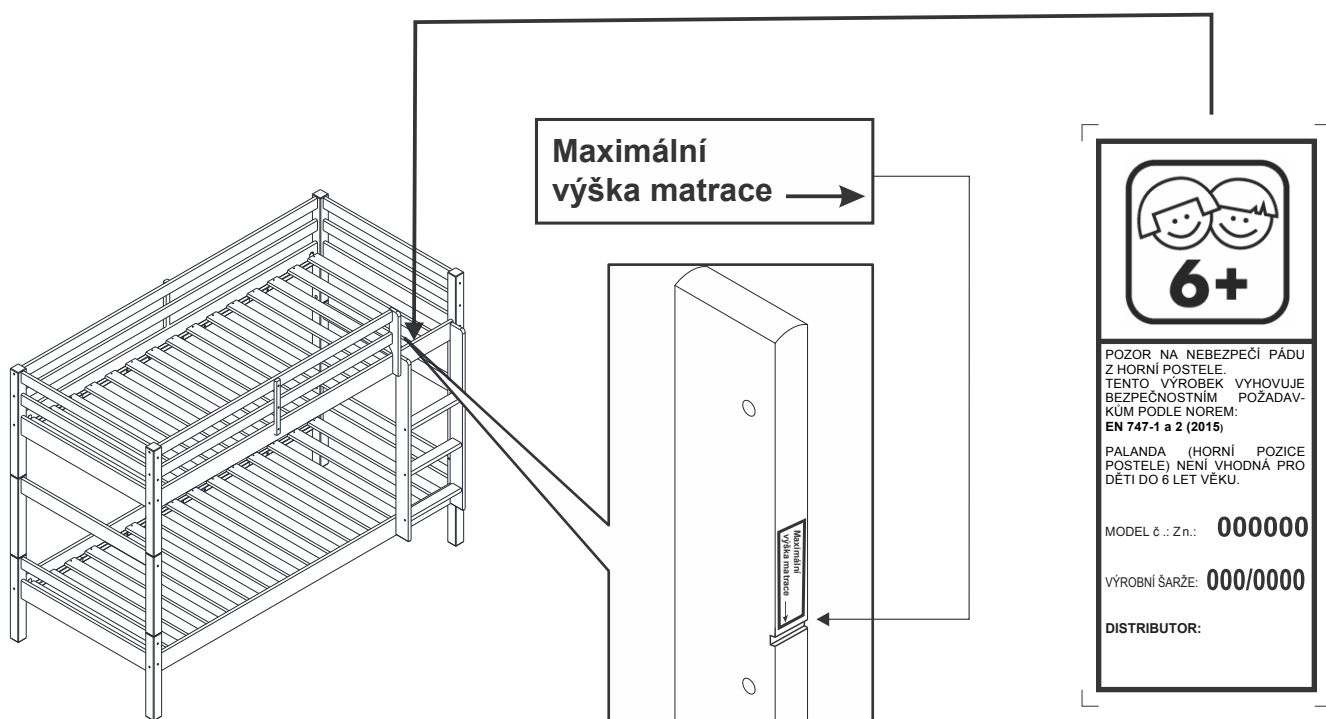

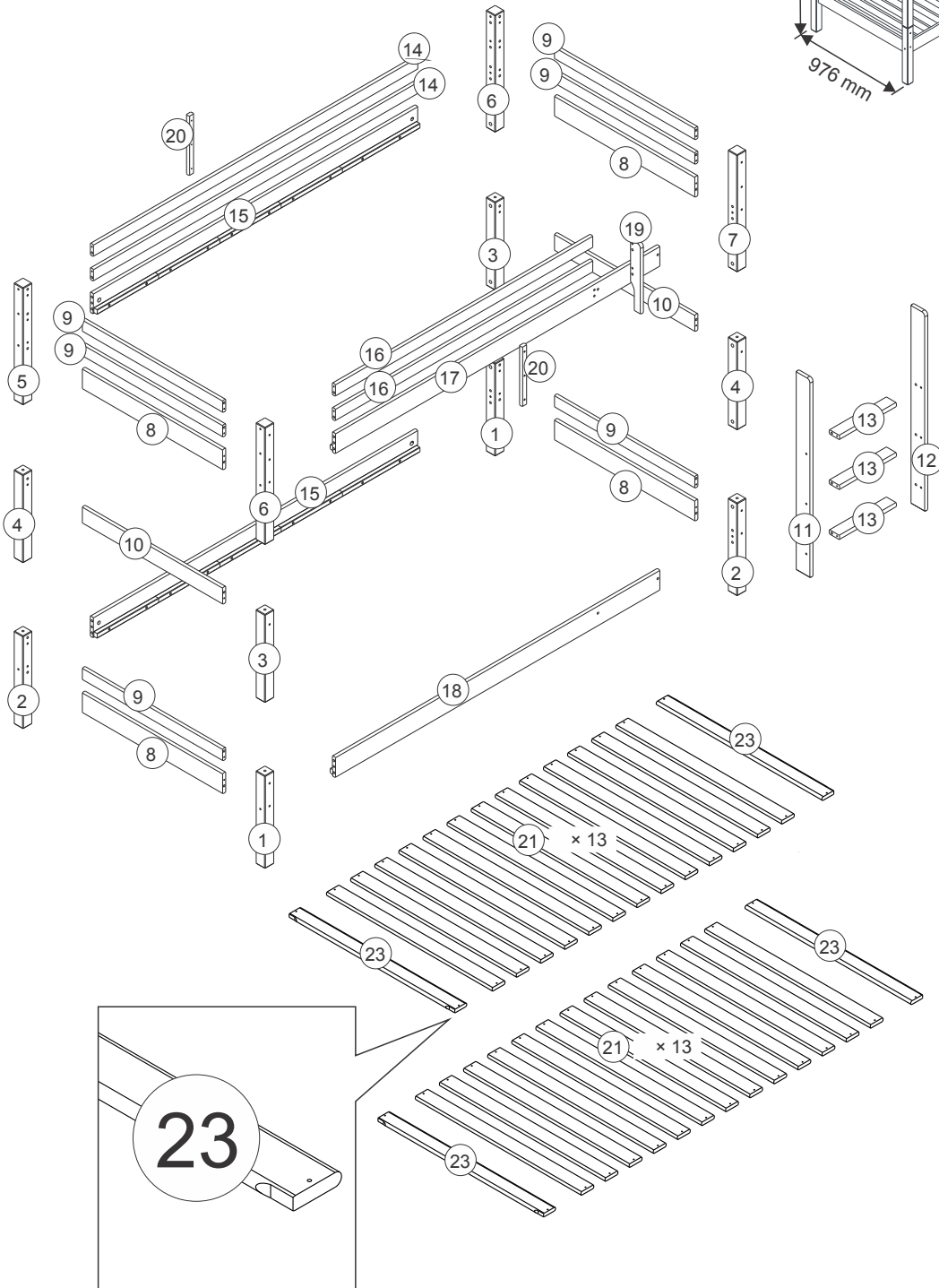
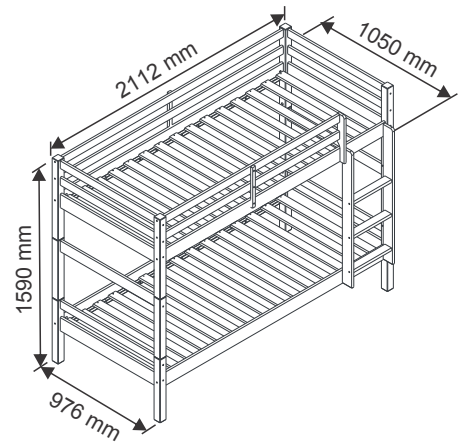

Giga 01

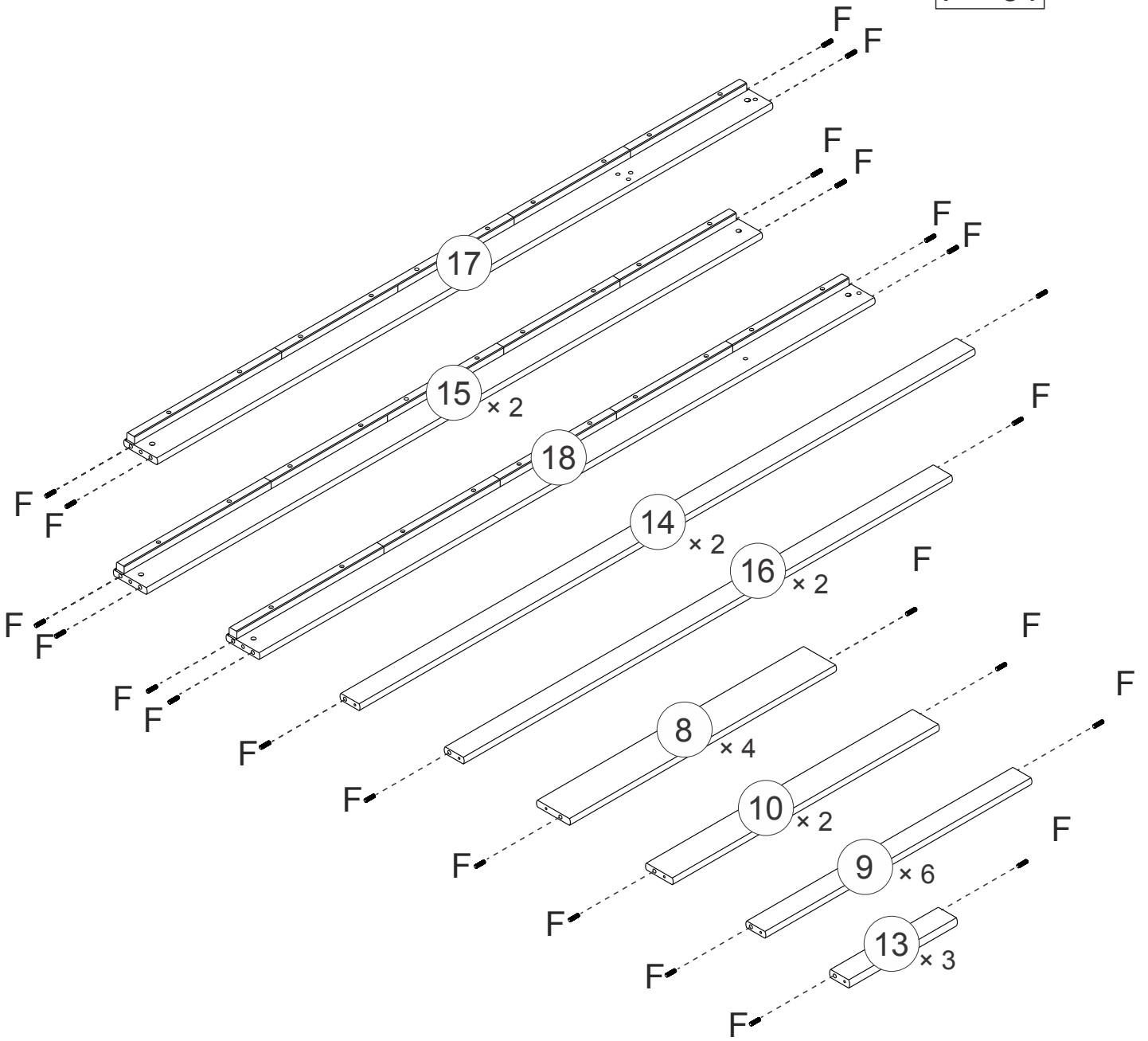
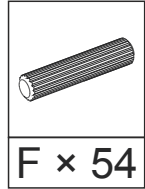



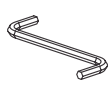
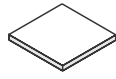

1

		
Q × 01	S × 04	C × 08

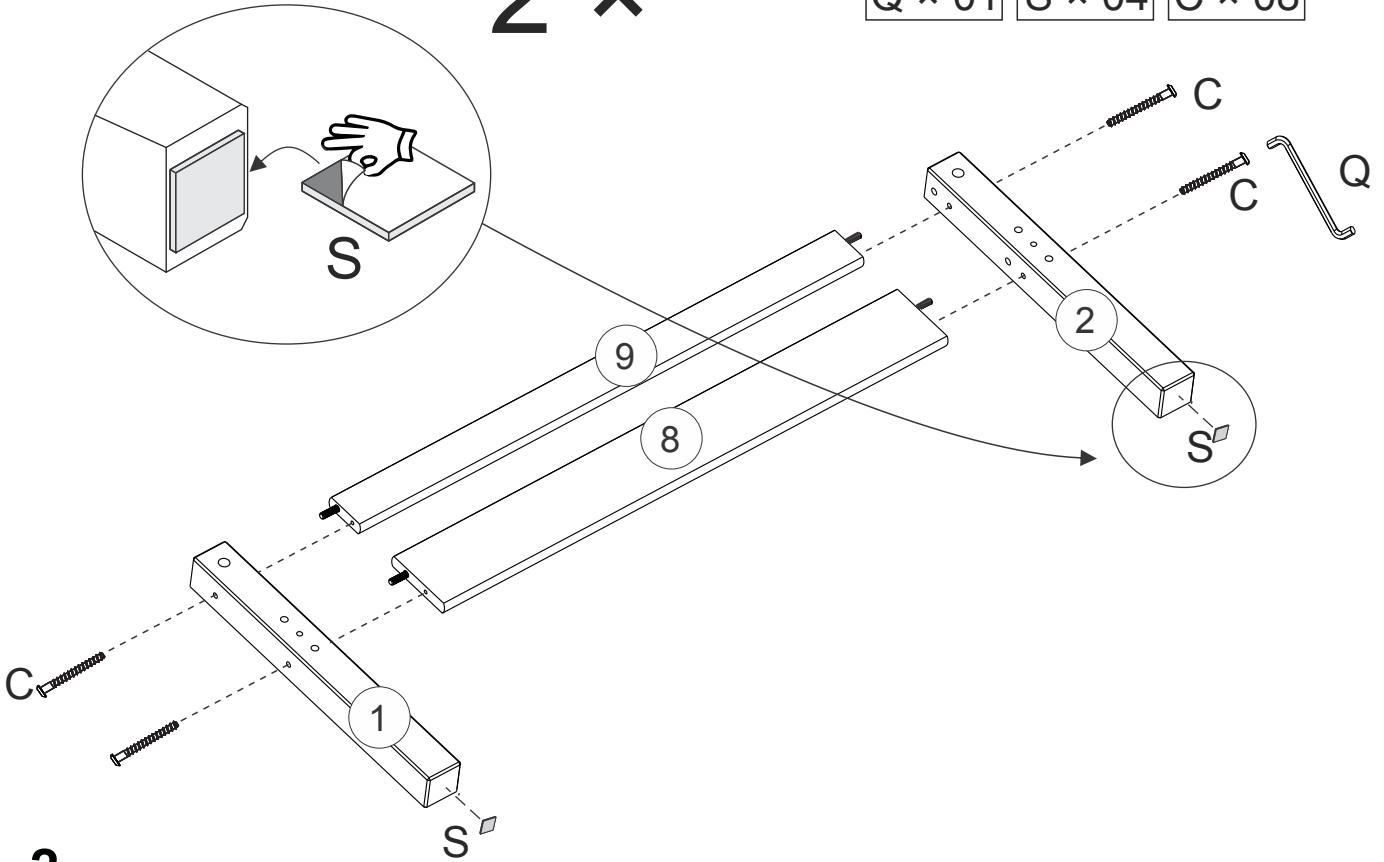
2 ×

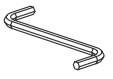

2

	
Q × 01	C × 04

2 ×

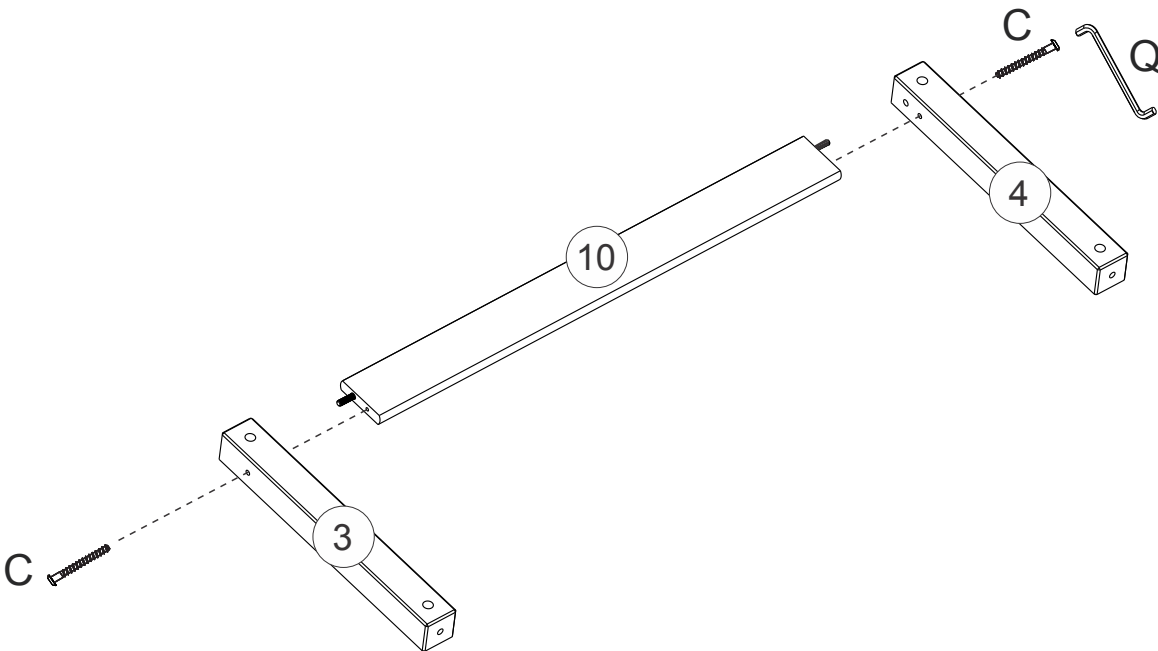

3

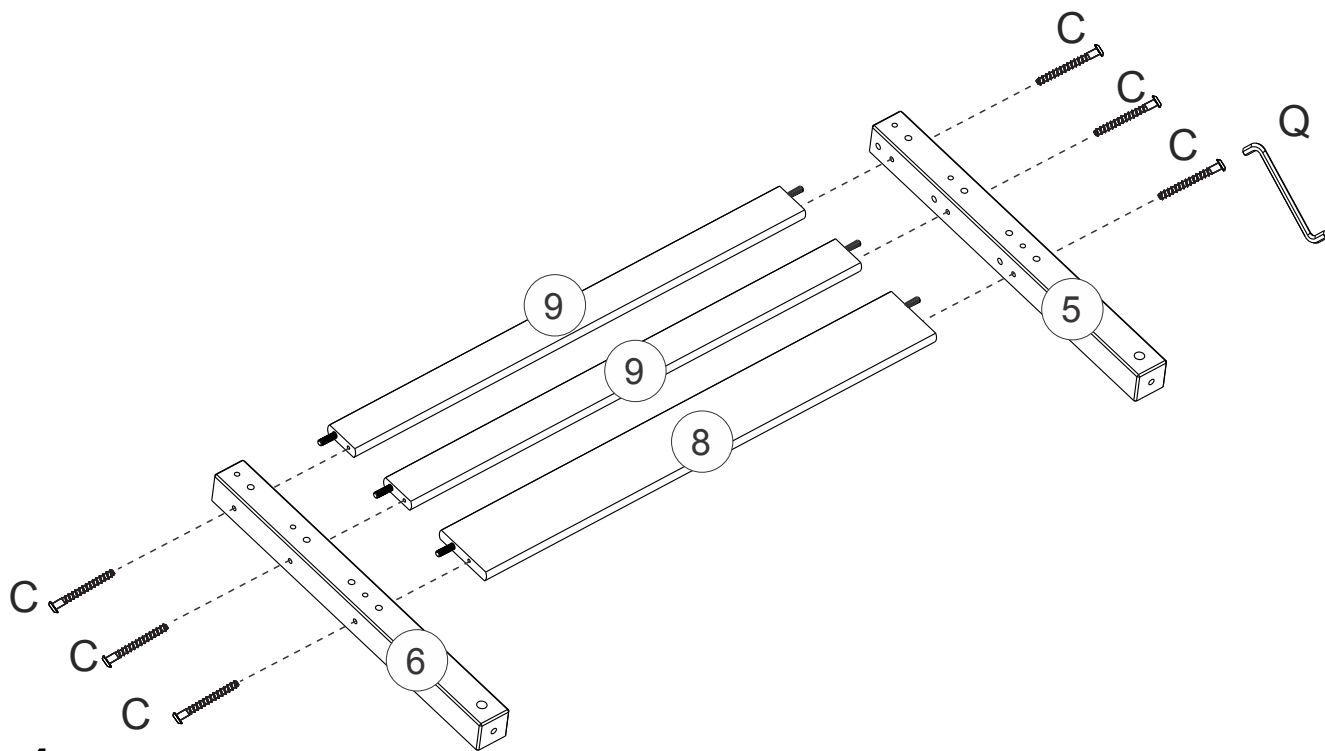
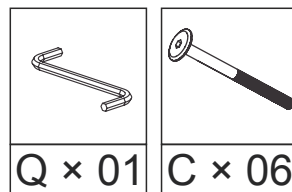

4

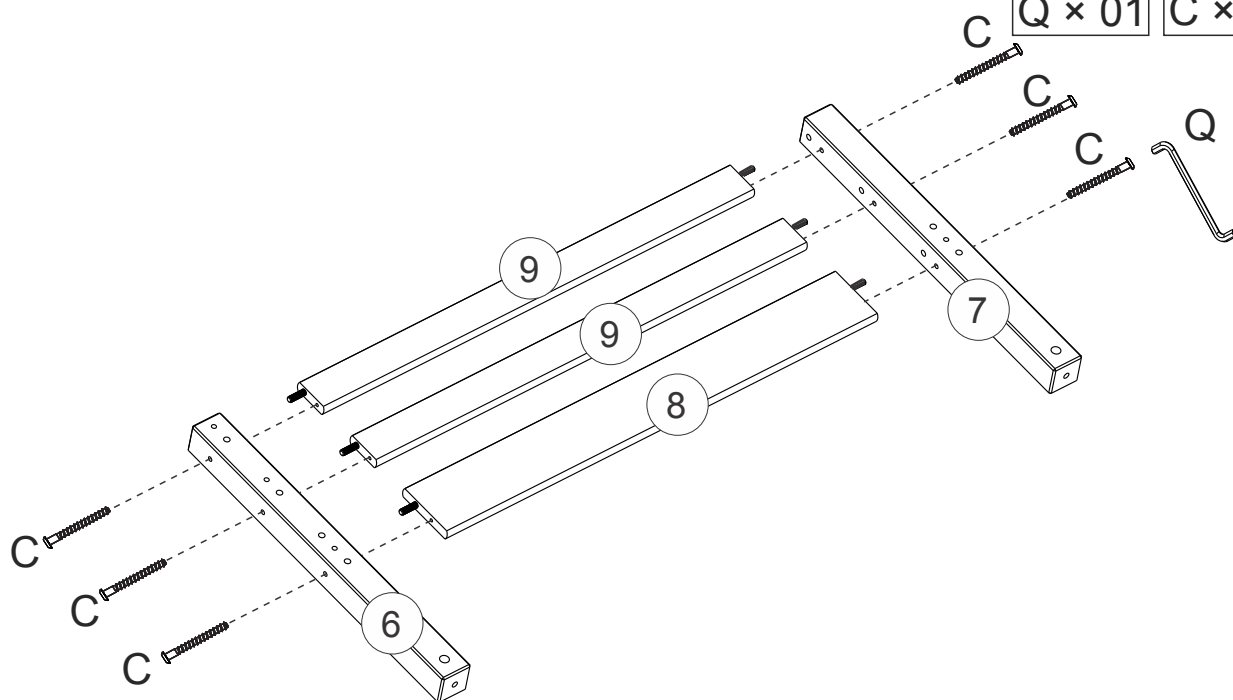
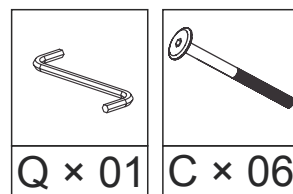

5

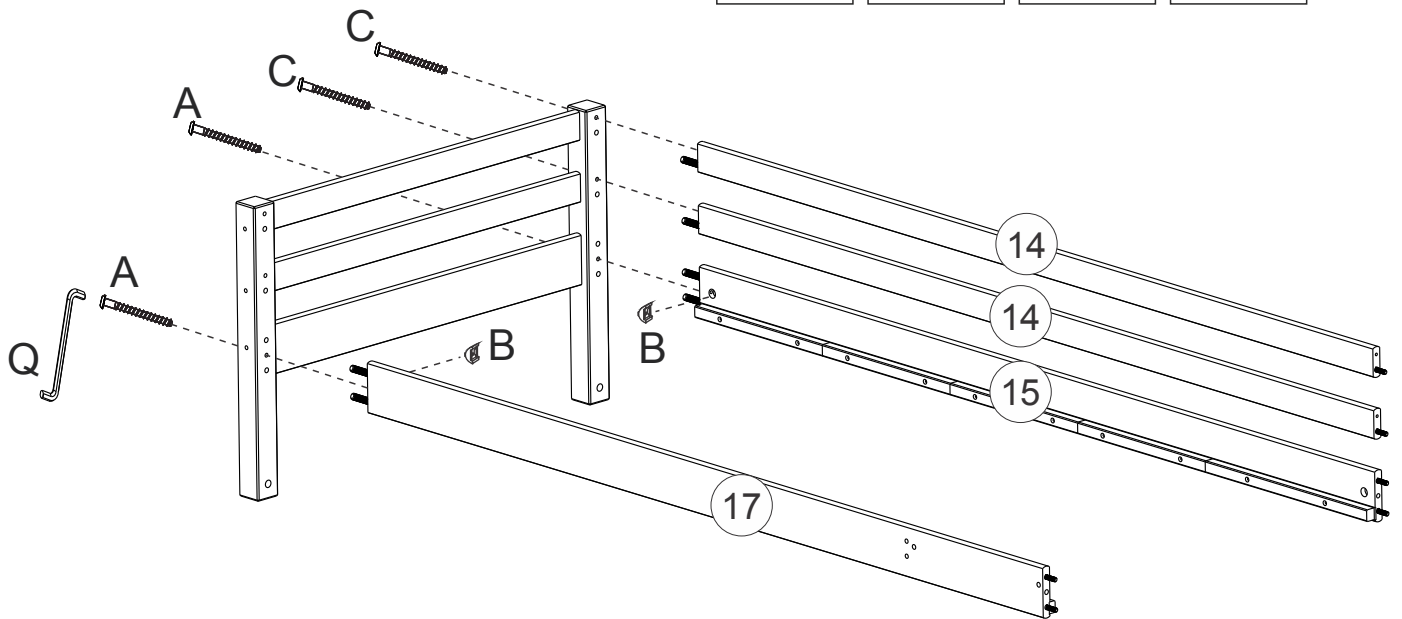
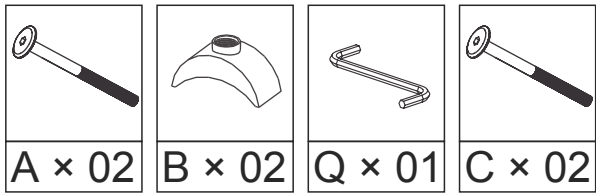

6

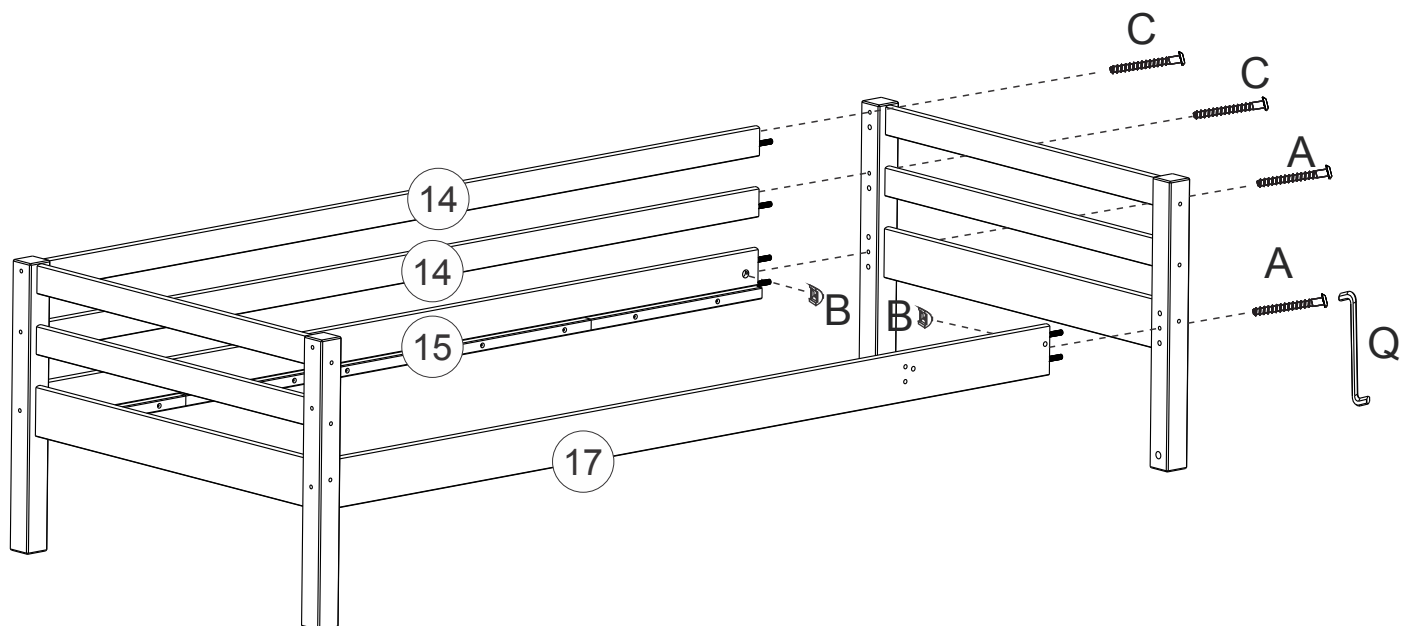
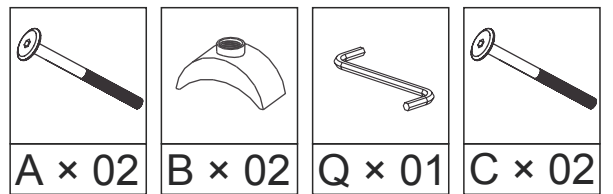

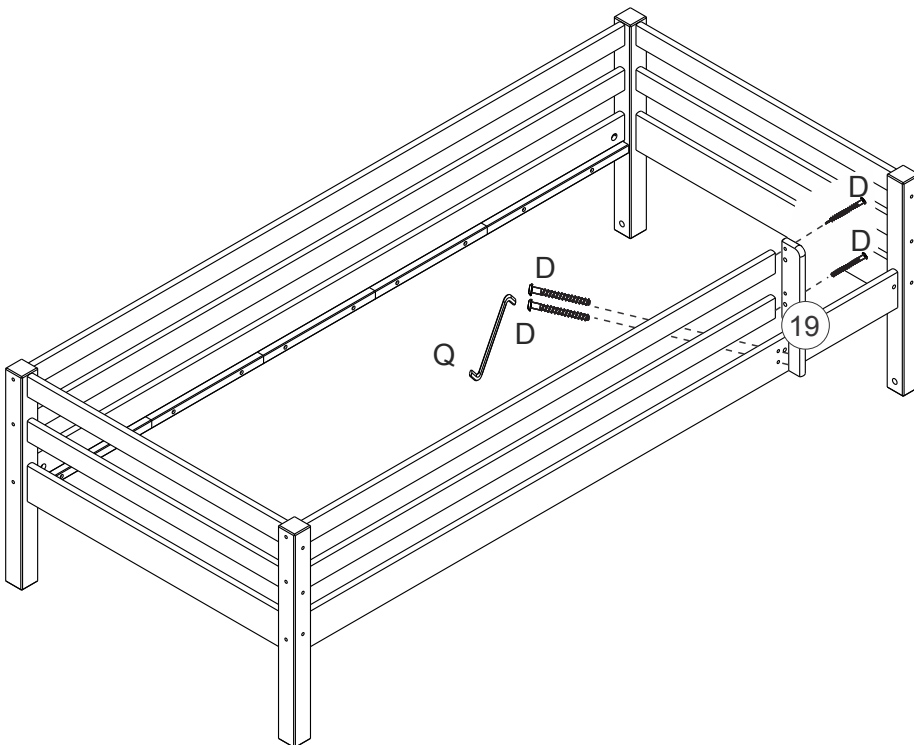
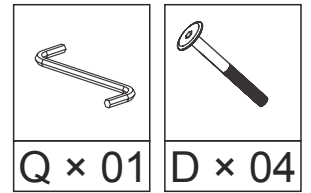
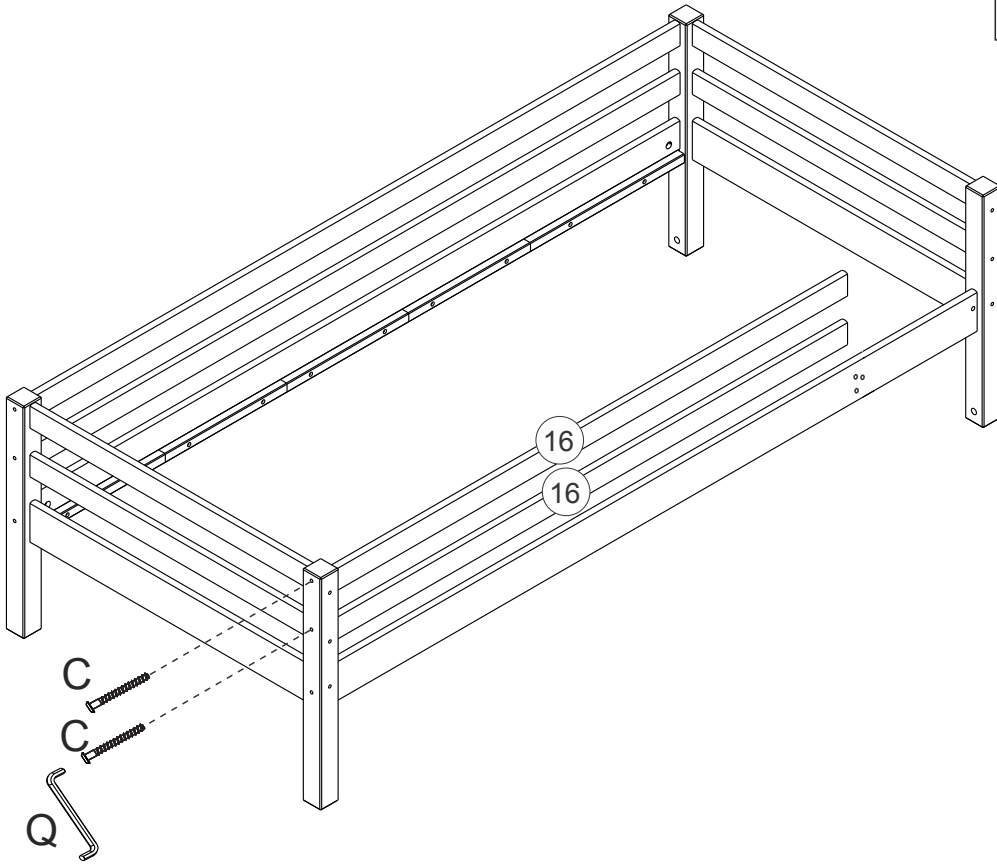
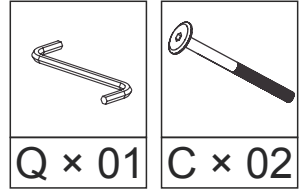

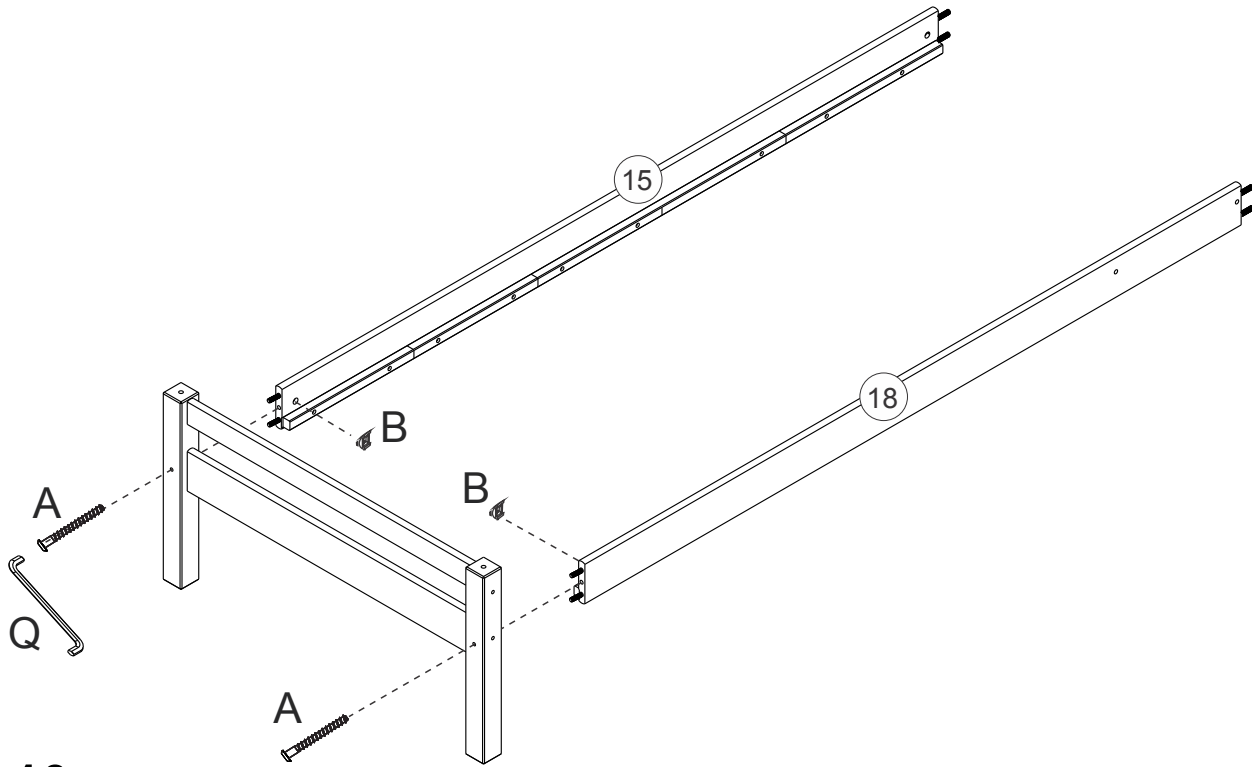
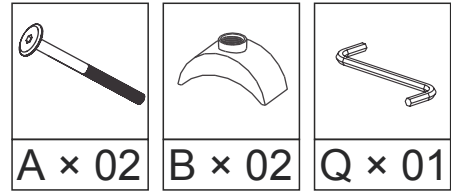

9



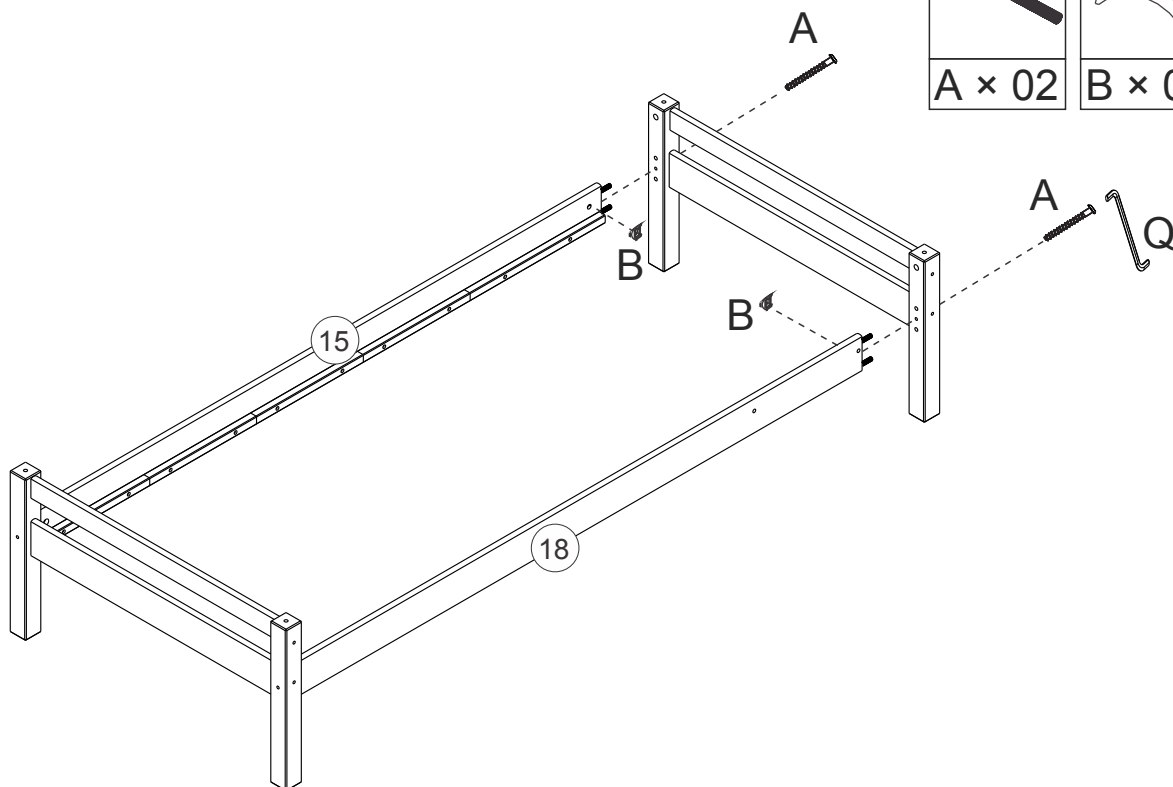
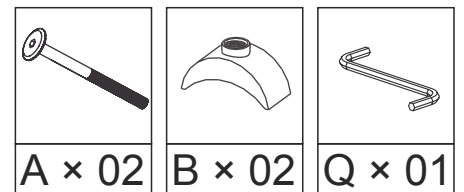

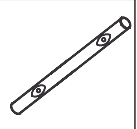
10

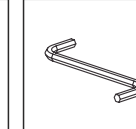

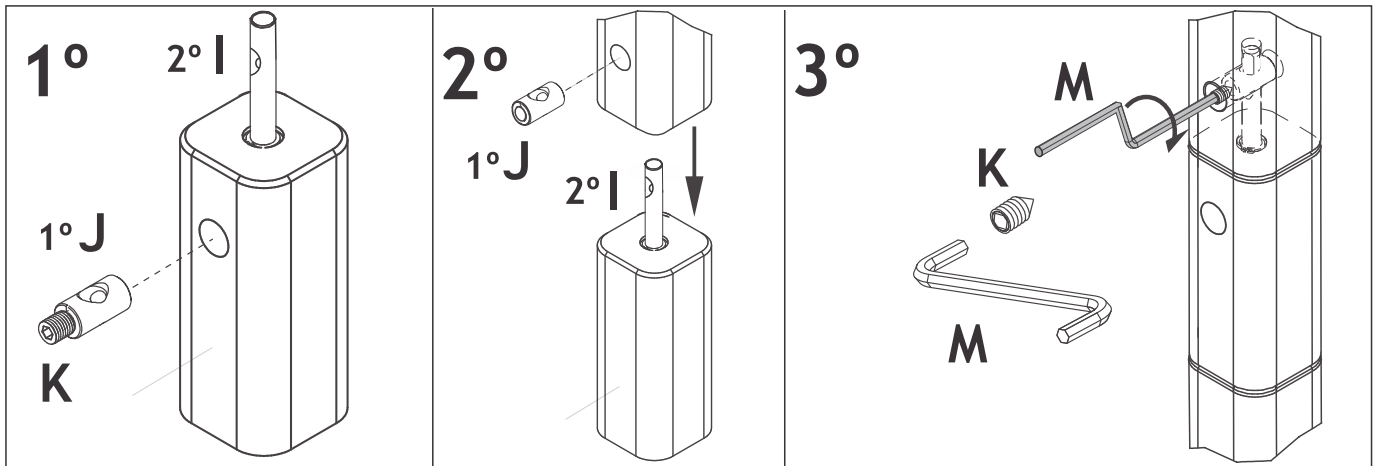
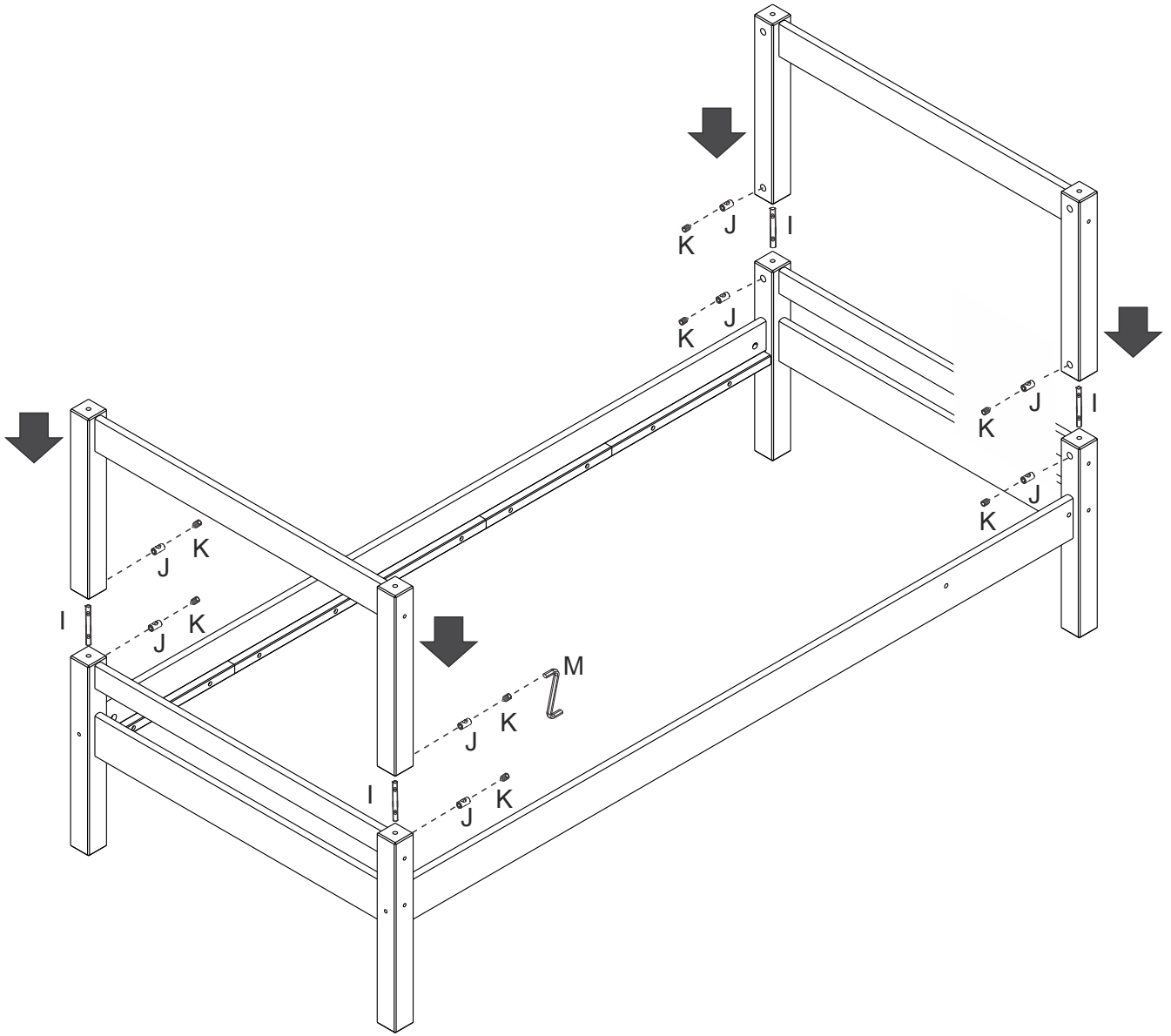
			
I × 04	J × 08	K × 08	M × 01

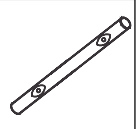

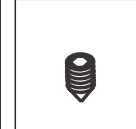
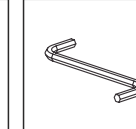
			
I × 04	J × 08	K × 08	M × 01

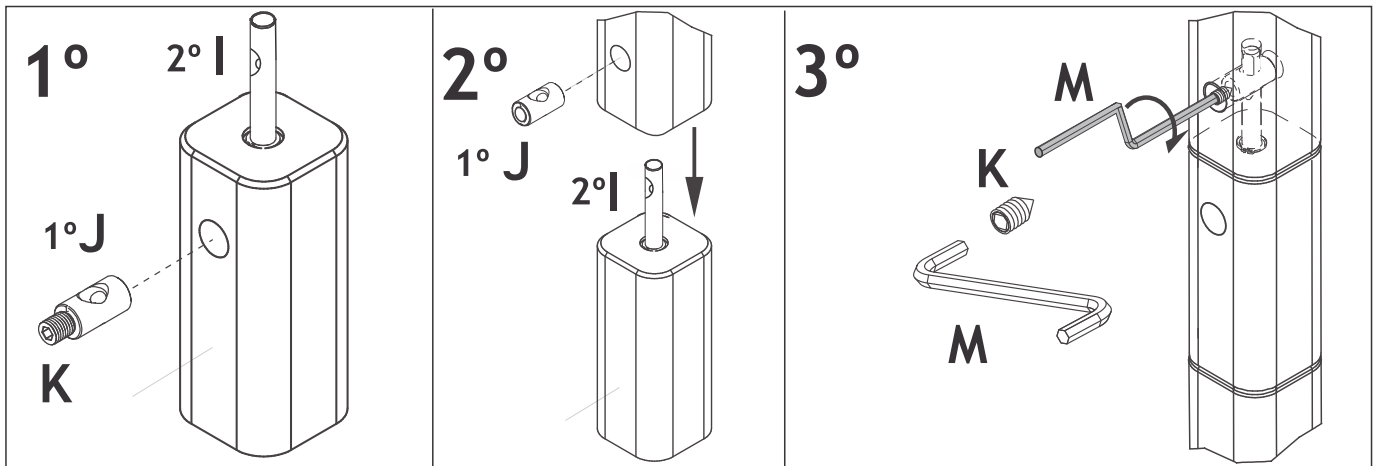
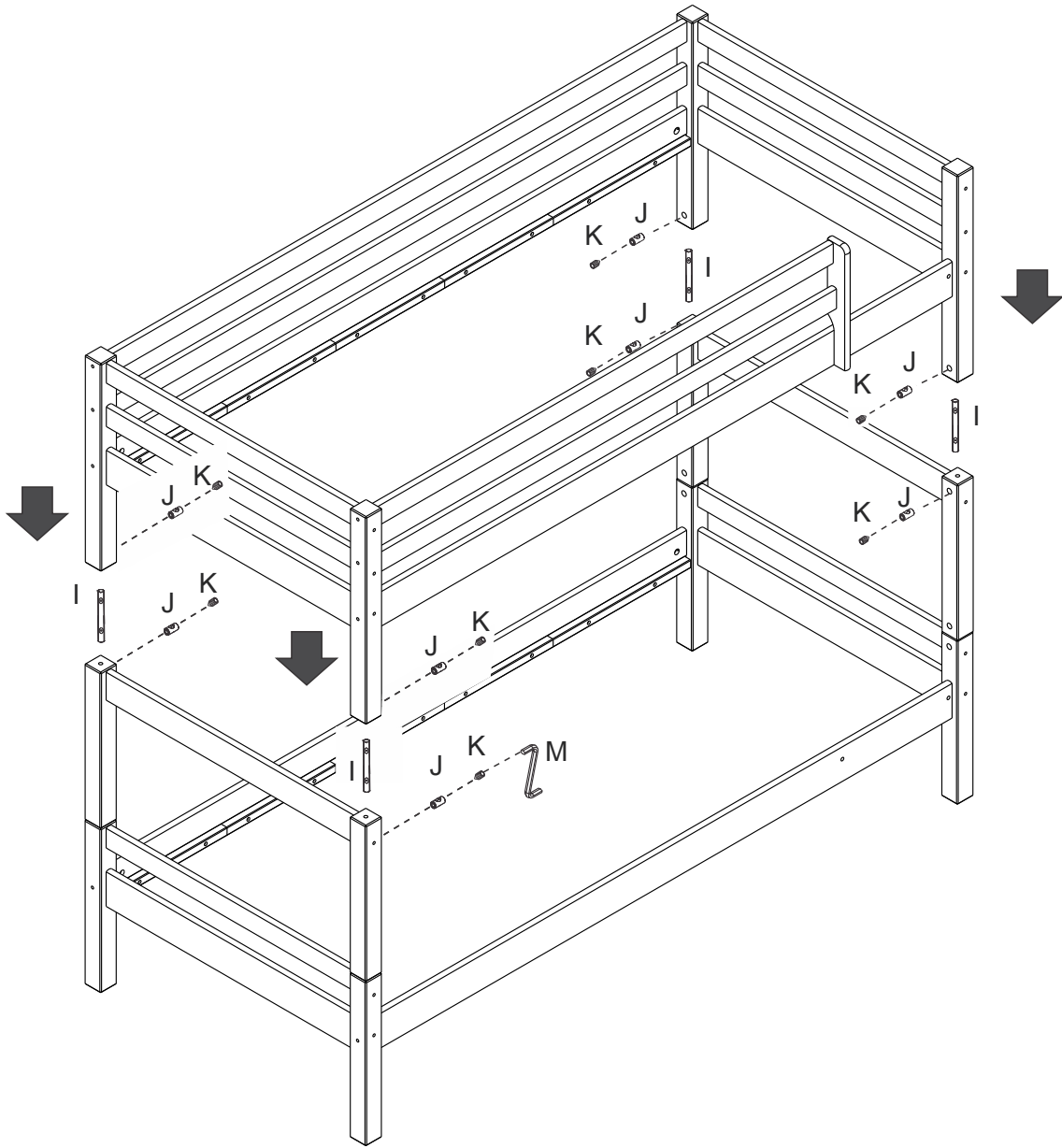

13

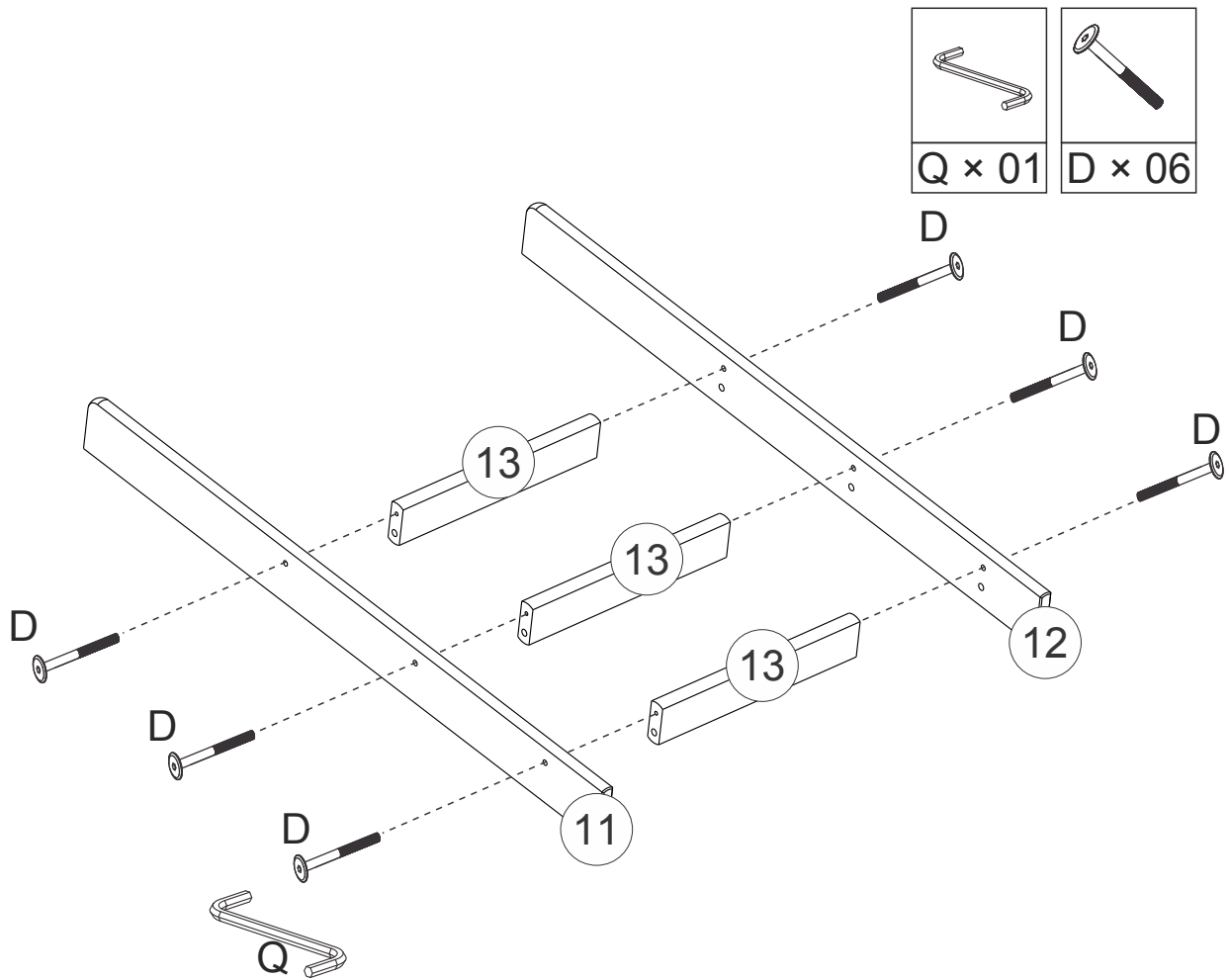

14

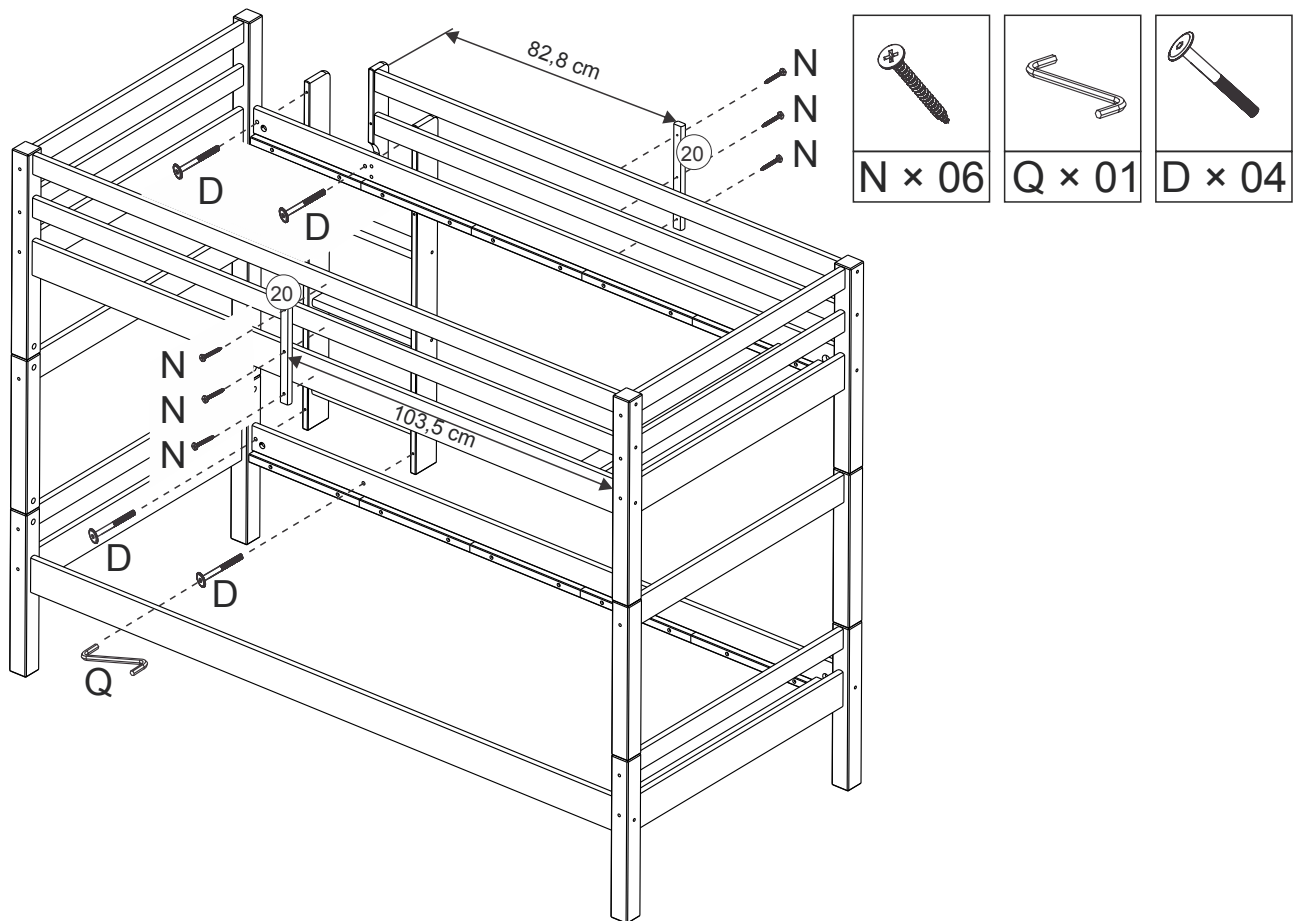

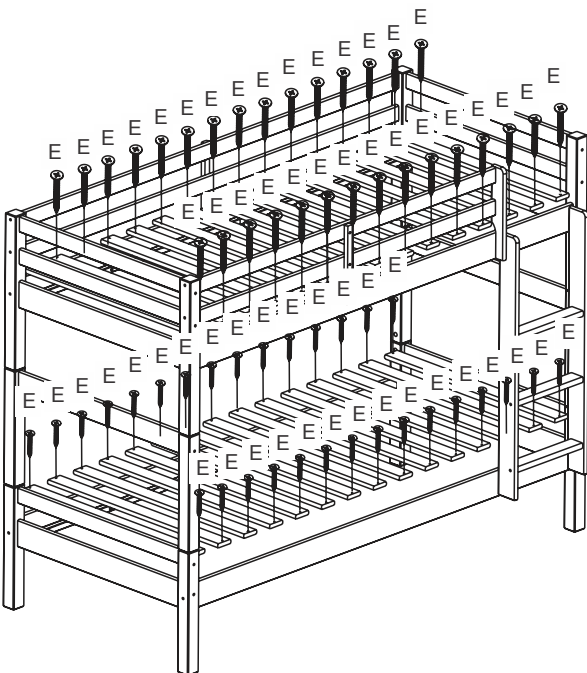
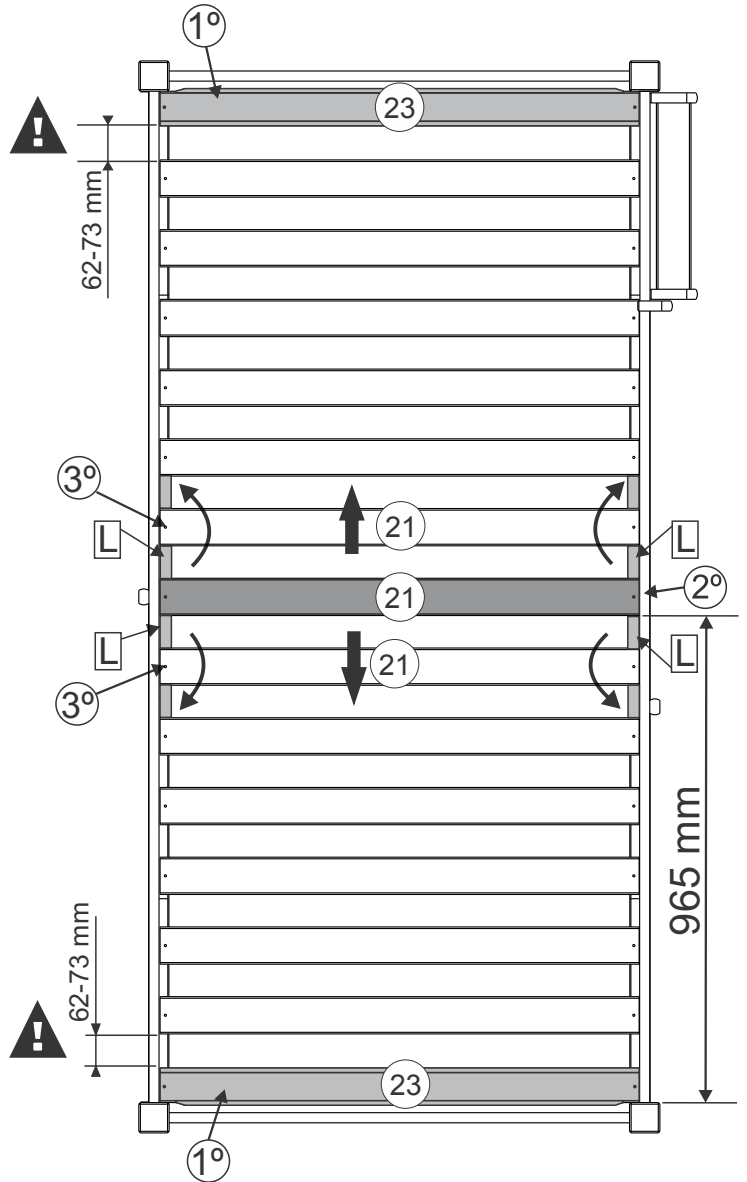
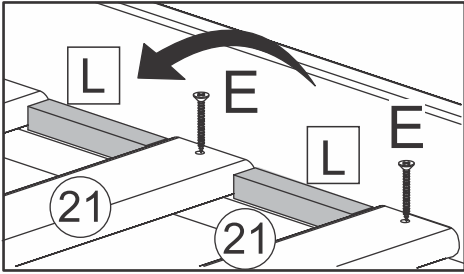
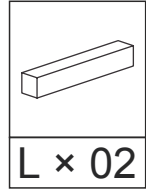
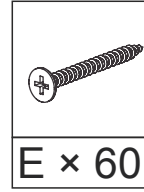
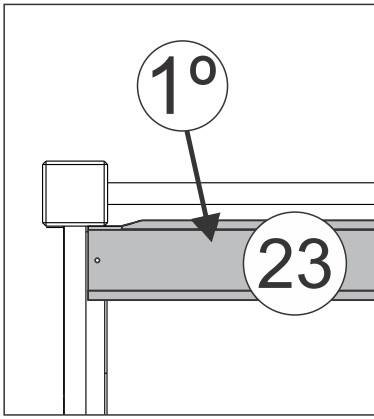

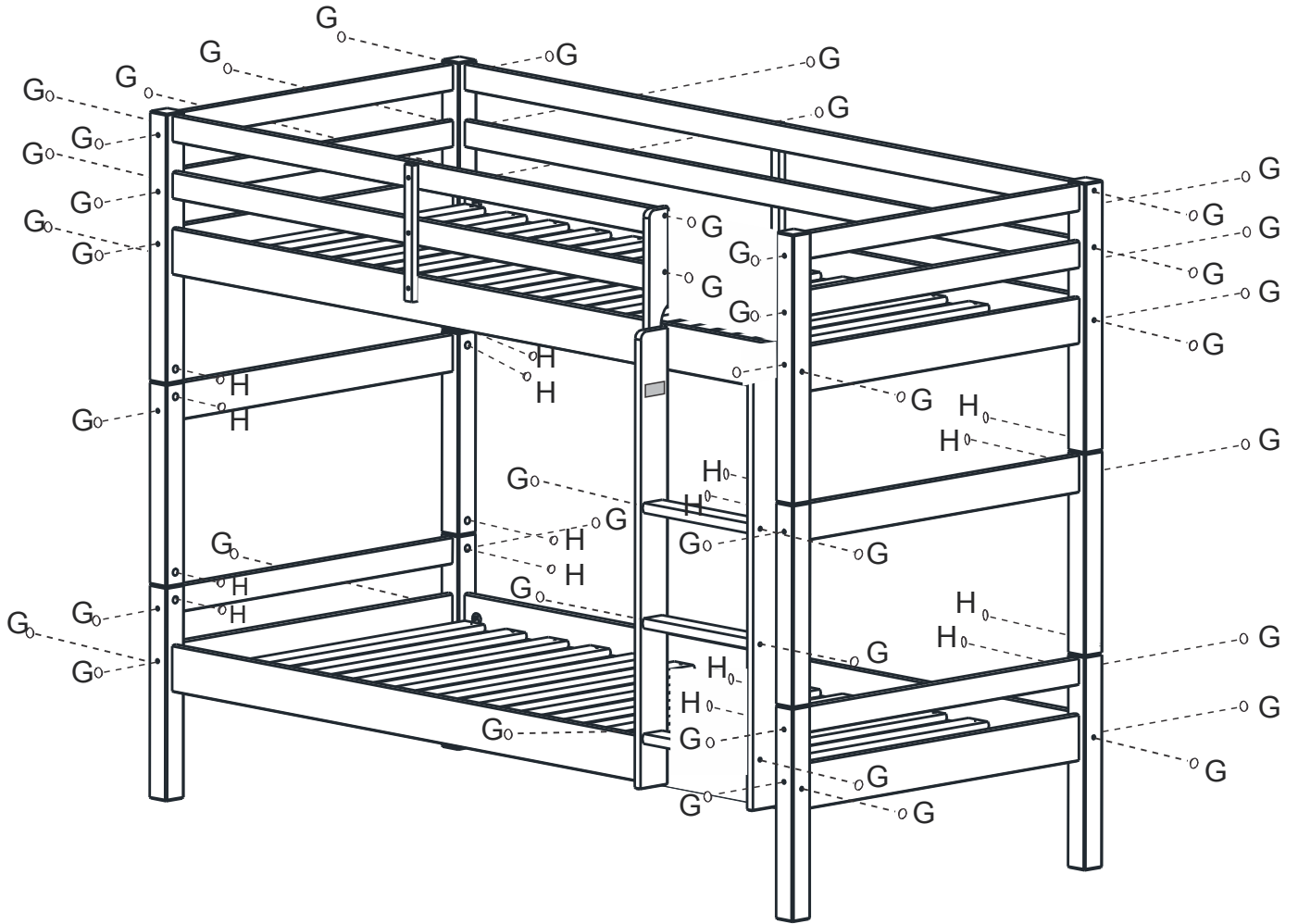
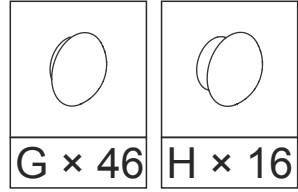

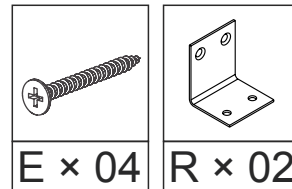

POZOR!
NUTNO PŘIPEVNIT KE ZDI

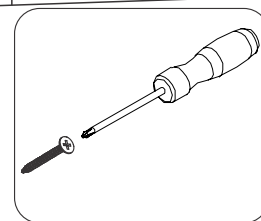
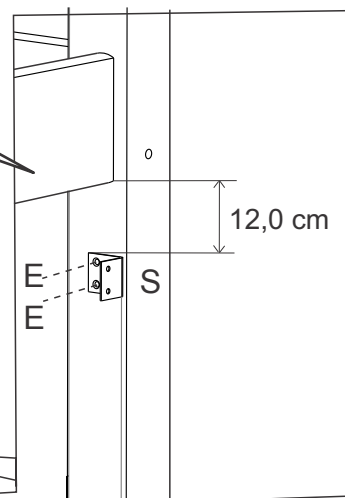
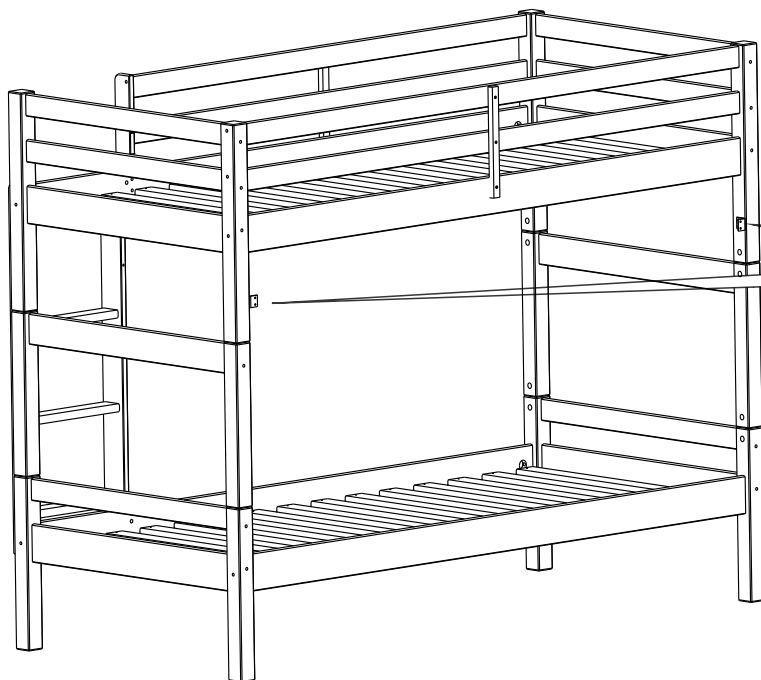

Existuje mnoho typů zdiva, a proto nemůžeme doporučit přesný způsob připevnění palandy.
Pro správné připevnění je třeba určit typ zdiva, ke kterému budete palandu připevňovat,
aby bylo dosaženo optimální pevnosti uchycení. Zde jsou některé příklady připevnění pro:



PEVNÉ ZDIVO (cihla, panel, pórobeton ap.)

DUTÉ ZDIVO (sádkokarton, dřevotřískka, duté cihly ap.)

Nylonová hmoždinka

Kovová kotva

Nylonová roztahovací hmoždinka

Kovová roztahovací hmoždinka

Kovová kotva

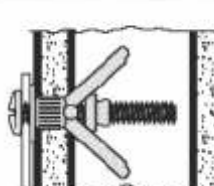
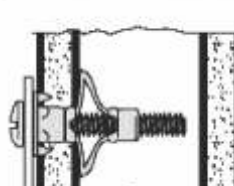
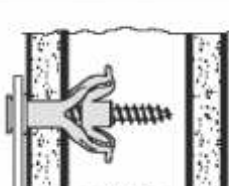
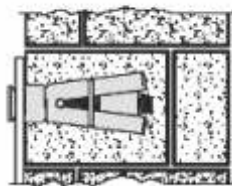
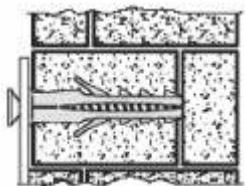
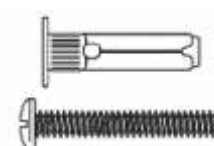
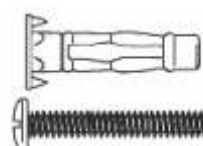
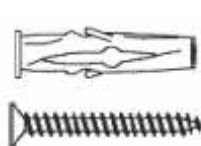
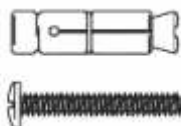
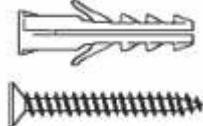

Vždy zvolte vrták vhodného typu a průměru podle typu zdiva a kotvicího materiálu!